

LANDSCAPE WORKS - OUTLINE SPECIFICATION

1.0 Site Preparation and Protection

1.1 Erosion Control: Take all precautions to prevent erosion.

1.2 Work Near Trees:

Excavation within 5 meters of an existing significant tree is to be supervised by a qualified consulting arborist.

Protect all trees to be retained from damage from groundwork.

Take all necessary precautions including the following:

Do not store, store, stockpile, dump, or otherwise place under or near trees bulk materials and harmful materials.

Do not place spoil from excavations against tree trunks, even for short periods. Prevent damage to tree trunks.

Do not fill or compact over tree roots within the drip line of the tree canopy. Undertake root protection / compaction

mitigation as required and specified by Council.

Do not remove topsoil from within the dripline of the line unless otherwise specified.

If it is necessary to excavate within the dripline, use hand methods to preserve intact root systems.

Do not cut tree roots exceeding 50mm diameter unless permitted by the superintendent.

1.3 Weed Eradication

Eradicate weeds by environmentally acceptable methods using a non residual herbicide at the recommended

maximum rate. Continue eradication throughout the course of works and during the planting establishment.

2.0 Soil Works

2.1 Garden Beds

Remove all weeds, roots, stumps, builders rubbish and other debris.

Garden Bed 1

GB1: In ground planting: Excavate to 375mm below finished levels. Shape to drain to subsoil drains where applicable.

Cultivate subgrade to 200mm.

Additives: After cultivation incorporate gypsum into upper layer of clay sub soils at the rate of .25kg/ m2

Spread topsoil mix to 300mm depth.

Individual plantings in existing garden bed areas. Excavate a hole twice the diameter of the rootball and at least 100mm deeper than the root ball. Break up the hole to a further depth of 100mm, and loosen compacted sides of the hole to prevent confinement of root growth.

GB2: Planter as detailed

GB3: Planters/ pots/ containers

Soil mix: 'S1' Organic soil mix in accordance with AS 4419 Soils for Landscaping and Garden Use.

Soil mix below 300mm: 'S2' 80:20 double washed river sand/soil mix

Soil mix 'S3' 100% double washed river sand

Mulch: Place 75mm horticultural grade much to all garden or nominated areas set down 25mm from adjacent surfaces.

Gravel Mulch: 50mm to nominated areas set down 25mm from adjacent surfaces.

Mulch to be free of deleterious matter, including soil, weeds, rocks, twigs and the like.

Place the mulch so that it does not come into contact with the stem.

2.2 Turf

Excavate to 100mm below finished levels. Shape to drain to subsoil drains where applicable.

Cultivate sub grade to 100mm.

Spread 80% sand/20% topsoil mix to turf areas. Screed soil smooth & level to finish 40mm below finished level.

Spread soil conditioner Dynamic Lifter or equal & wet to activate.

Turf Type: 'Sir Walter'

Place turf in stretcher bond pattern with the joints staggered and close butted. Tamp lawn down. Water immediately after laying.

Apply lawn fertiliser at the completion of the first and last mowing.

When the turf is established, mow, remove cuttings and lightly topdress to a depth of 10mm.

2.3 Planting

Thoroughly water the plants before and immediately after planting and as required to maintain growth rates free from stress.

Excavate a hole, double the width and 200mm deeper than the pot size. Cultivate the subgrade to 150mm.

Backfill with topsoil mixture. Water in well.

2.4 Fertiliser

Turf: Apply an approved complete lawn fertiliser at the manufacturers recommended application and rates.

Planting: Individual plantings: Place fertiliser pellets at a rate as recommended by the manufacturer.

Planting beds: Place prolonged release fertiliser around the plants as recommended by the manufacturer.

2.5 Staking

For plants greater than 2.5M high provide 3 x 50mm x 50mm stakes per plant.

For plants 1-2.5M high provide 2 x 50mm x 50mm x 1.8m per plant.

3.0 Subsoil Drains

General: Provide subsoil drains to intercept groundwater seepage and prevent water build-up behind all walls & pavements.

Connect subsoil drains to surface drains or to the stormwater drainage system as applicable.

Pipe Type: 100mm slotted, flexible corrugated PVC pipe and fittings to AS 2439.1.

Bed piping on a continuous underlay of bedding material, at least 75 mm thick after compaction.

Pipe surrounds:General: Place the material in the pipe surround in layers 200 mm loose thickness, and compact damaging or displacing the piping.

Filter Fabric:Provide polymeric fabric formed from plastic yarn composed of at least 85% by weight propylene, ethylene, amide or vinylidenechloride, containing stabilisers or inhibitors which provide resistance to deterioration due ultraviolet light.

4.0 Irrigation

Design, supply, install and commission a fully automatic fixed waterwise drip irrigation system to all planting areas.

The irrigation system shall be designed and constructed to ensure even distribution and sufficient water to achieve even growth

Ensure that the irrigation system is capable of providing a minimum precipitation rate of 25mm per week.

All irrigation must comply with the water and electricity supply authorities, local authority standards and relevant Australian standards.

Submission of the design to the client or their superintendent prior to the commencement of the works is the responsibility of the irrigation contractor.

5.0 Planting

All plant material shall be true to type of healthy growth, disease free nursery stock and not displaying restricted growth patterns.

Should there be a requirement for substitutions they shall not change without prior approval of the Landscape Architect.

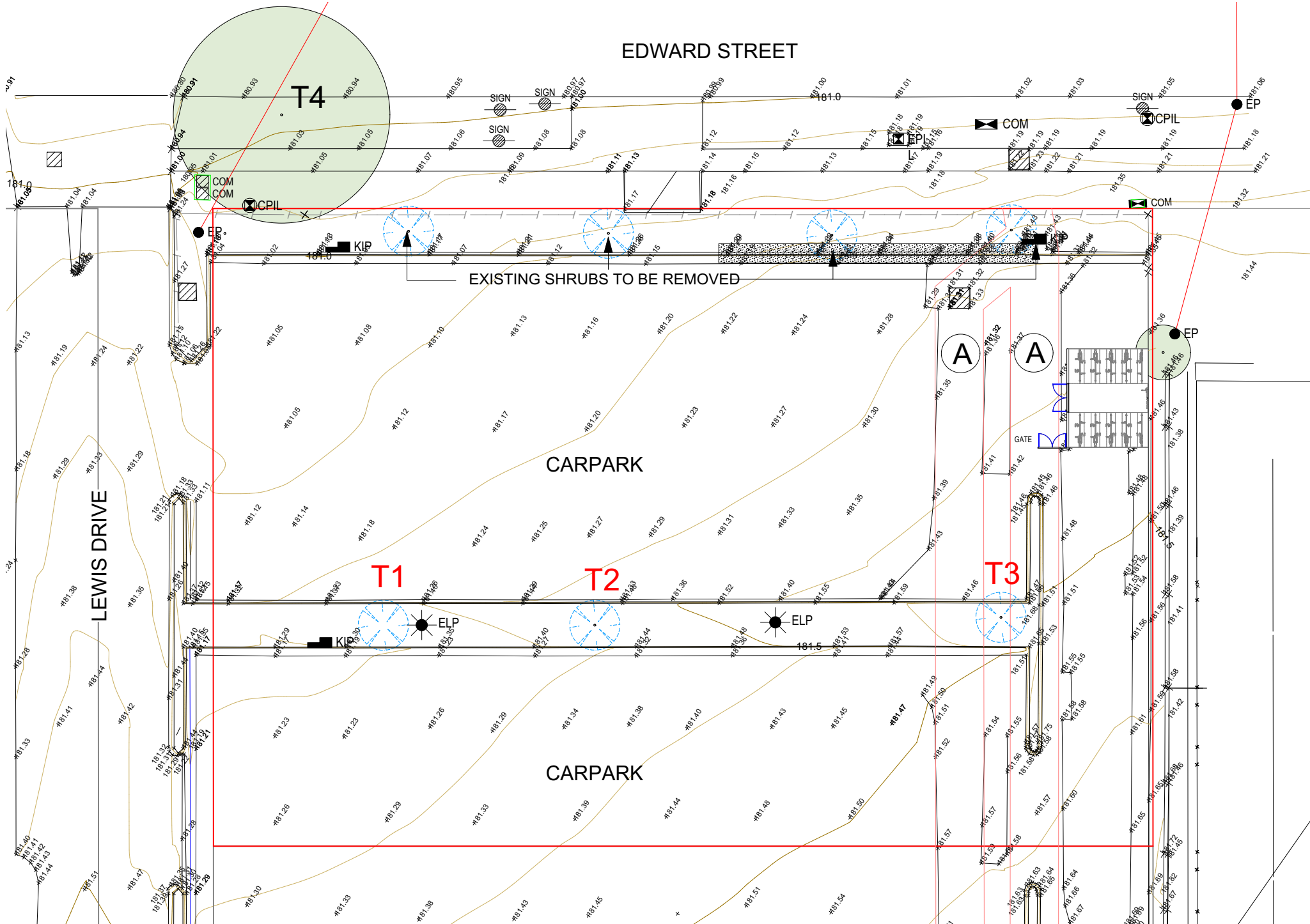

A EXISTING SITE/ TREE PLAN
1:250

EXISTING TREE SCHEDULE

Tree Ref	Botanical Name	Common Name	Approx. H X S(M)	Condition	Comments
T1	Pyrus calleryana	Callery Pear	4.5 x 2.5	Good	Remove
T2	Pyrus calleryana	Callery Pear	4.5 x 2.5	Good	Remove
T3	Pyrus calleryana	Callery Pear	2.5 x 1.5	Good	Remove
T4	Jacaranda mimosifolia	Jacaranda	8 x 11	Good	Located in verge. Retain and protect

PROPOSED PLANT SCHEDULE

ID	Botanical Name	Common Name	Scheduled Size	Mature Height	Mature Spread	Qty	Remarks
Trees							
Li'N'	Lagerstroemia indica 'Natchez'	Crepe Myrtle	200Lt	5 - 10m	3.5 - 6m	6	Clear straight trunk to 1m
Trl	Tristaniopsis laurina	Kanooka, Water Gum	200Lt	5 - 10m	3.5 - 6m	1	Clear straight trunk to 1m
Shrubs							
Cm'DS'	Carissa macrocarpa 'Desert Star'	Natal Plum	200mm	0.9 - 1.5m	1.2 - 2.0m	51	
Ro 'OP'	Rhaphiolepis indica 'Oriental Pearl'	Oriental Pearl	200mm	0.9 - 1.5m	1.2 - 2.0m	135	
Sa'BB'	Syzygium australe 'Baby Boomer'	Rose Apple	200mm	0.9 - 1.5m	0.9 - 1.2m	20	
Sr	Syzygium australe 'Resilience'	Resilience Lilly Pilly	300mm	3 - 5m	1.2 - 2.0m	4	Hedged to 2m
Tfr	Teucrium fruticans	Bush Germander	200mm	1.5 - 3m	1.2 - 2.0m	90	
Wf'M'	Westringia fruticosa 'Mundii'	Dwarf Coastal Rosemary	200mm	0.1 - .3m	0.5 - 1m	60	
W'WG'	Westringia fruticosa 'Wynyabbie Gem'	Wynyabbie Gem Coast Rose	200mm	1.0-1.2m	1.0-1.2m	22	
Ground Covers							
Grasses							
Li	Lomandra longifolia	Spiny-headed Mat-Rush	140mm	0.75 - 0.9m	0.9 - 1.2m	8	
Li'T'	Lomandra longifolia 'Tanika'	Spiny-headed mat rush	140mm	0.45 - 0.6m	0.6 - 0.9m	107	
P'PL'	Pennisetum 'Purple Lea'	Purple Fountain Grass	140mm	0.75 - 0.9m	0.6 - 0.9m	58	
Climbers							
Aquatic Plants							
Perennials							
Ferns							
Total						562	

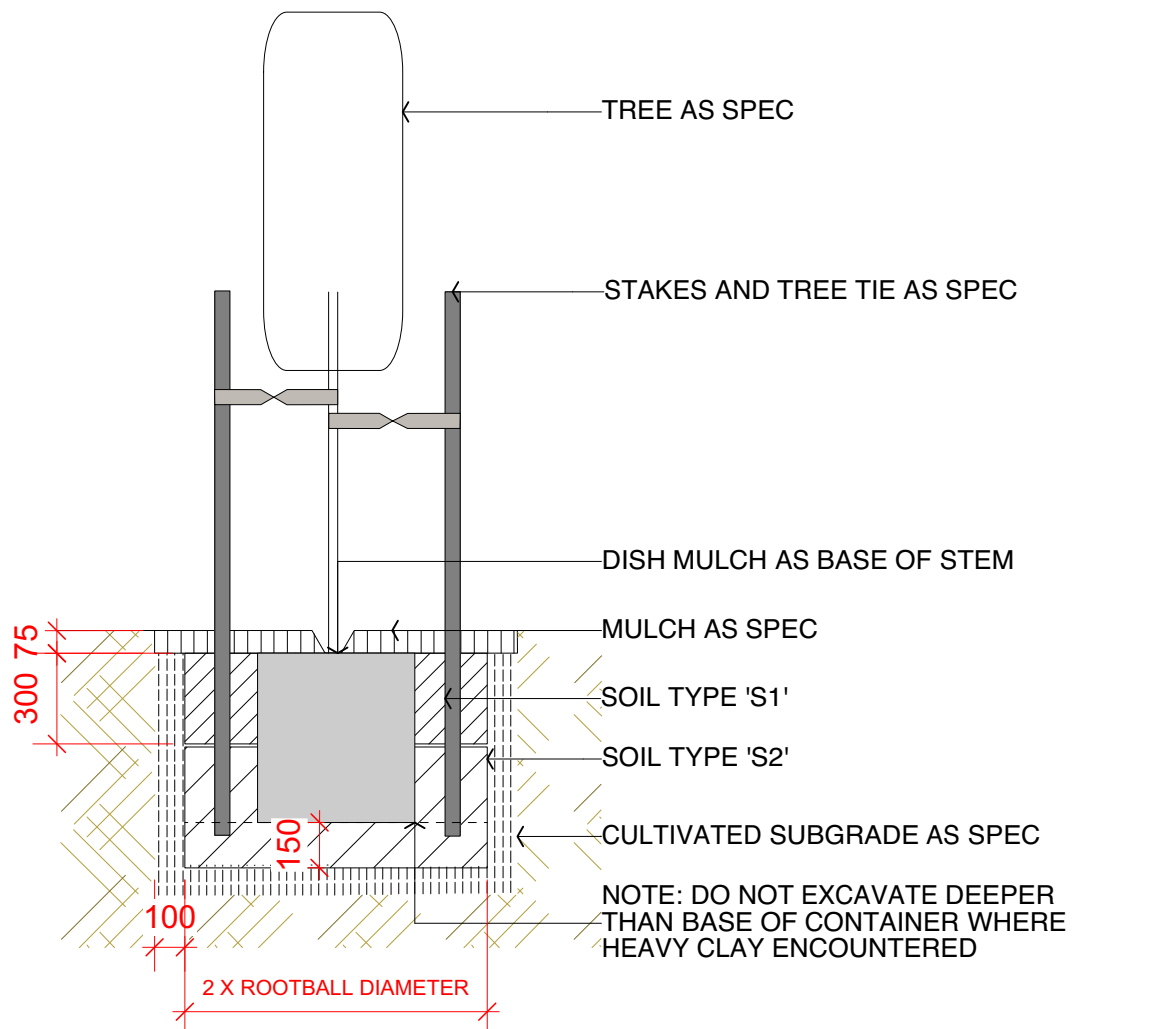

1 TREE PLANTING DETAIL
1:25

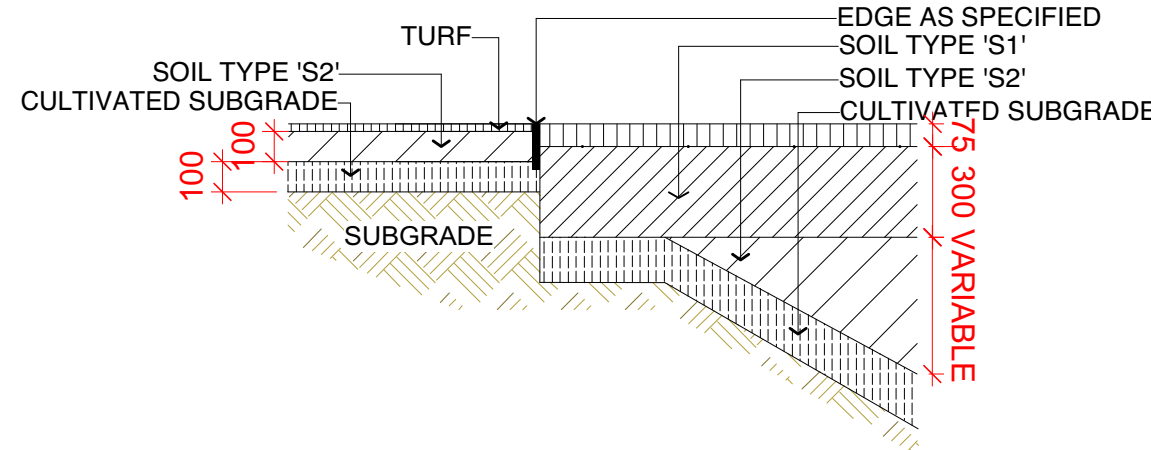

2 GARDEN & TURF DETAIL
1:25

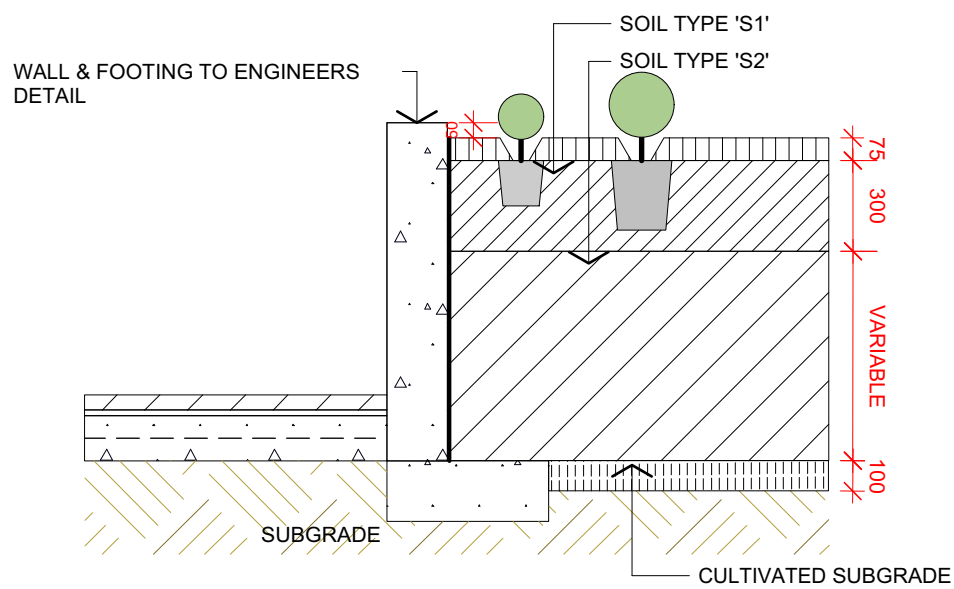

3 PLANTER DETAIL
1:25

				LANDSCAPE ARCHITECT:	PROJECT:	CLIENT:	SCALE:	DRAWING TITLE:
				FIONA YEATES Consulting Pty Ltd	UNSW BIOMEDICAL SCIENCES CENTRE	UNSW Sydney	AS SHOWN @ A1 50% @A3	LANDSCAPE DETAILS & SPECIFICATIONS
				LANDSCAPE ARCHITECTURE URBAN DESIGN	WAGGA WAGGA BASE HOSPITAL	NSW 2052		
D	DEVELOPMENT APPLICATION	16.04.20	FY					
C	DEVELOPMENT APPLICATION	07.04.20	FY					
B	DEVELOPMENT APPLICATION	03.04.20	FY					
A	DEVELOPMENT APPLICATION	02.04.20	FY					
P	FOR COORDINATION	25.03.20	FY					
REVISION	DESCRIPTION	DATE	BY					